

Tactile safety inspection of high-level fabric

REPORT
Melrose Abbey
PIC 157



HISTORIC
ENVIRONMENT
SCOTLAND

ÀRAINNEACHD
EACHDRAIDHEIL
ALBA



CONTROL SHEET

Document Control

Title:	Tactile safety inspection of high-level fabric Report PIC157 - Melrose Abbey
Authors:	[REDACTED]
Document created:	June 2021
Reviewed by:	[REDACTED]
Date Reviewed:	04.03.22
Approved by:	
Date of Approval:	
Version Number:	V0100

Version Control

Version	Date	Status	Prepared by	Amendments
V0001	07/06/2021	Draft	[REDACTED]	First draft
V0002	08/10/2021	Draft	[REDACTED]	Updated to include Identified Risk Elevations
V0003	17/12/2021	Draft	[REDACTED]	Links to IR drawings & OBS forms added. IR drawings revised to include OBS with access restrictions
V0100	04/03/2022	Approved	[REDACTED]	Approved

High-Level Tactile Inspection: Report - Introduction



PIC ID # ↓	PIC157	Site name	Melrose Abbey & Precinct		
Inspection start	10/05/2021	Inspection end	11/06/2021	Submission	10/02/2022
Lead assessor	[REDACTED]				
Other assessors	[REDACTED]				

Introduction:

The High-Level Fabric Inspection of Melrose Abbey was led by [REDACTED], Historic Building Fabric Assessor (HBFA) and carried out with HBFA [REDACTED] from 10th of May - 11th of June 2021. The Tier 1 Team assessed 27 zones covering the whole monument, using a range of high level access equipment including rope access, MEWP and ladders. Ground mats or alloy tracks were installed below MEWPs to protect the ground and archaeologically sensitive areas.

HLF Inspection Risk Matrix:

HES-T1C-HLF-RAS-X-X-V0201-RiskMatrix

Consequence \ Probability		1	2	3	4	5
		No injury	Minor injury	Moderate injury	Major injury	Fatal or life-altering injury
5	Fabric fall almost certain	5	10	15	20	25
4	Fabric fall highly likely	4	8	12	16	20
3	Fabric fall likely	3	6	9	12	15
2	Fabric fall unlikely	2	4	6	8	10
1	Fabric fall highly unlikely	1	2	3	4	5

RISK RATING	RISK SCORE RANGE
High	15 - 25
Medium	10 - 14
Low	1 - 9

Re-inspection frequency: (in years)

[REDACTED]



		Annual Visitor Numbers				
		up to 5 k	5-20 k	20 - 100 k	100k - 2m	over 2 m
Identified Risk Rating	Low	5 years	5 years	5 years	4 years	4 years
	Medium	3 years	3 years	2.5 years	2 years	2 years
	High	1 year	1 year	1 year	1 year	0.5 year

HL Zones:

Zone:	Colour:	Zone Name:
1		Nave - West wall of South aisle chapels
2		South Nave Aisle Chapel Aisle 1 - 5
3		Nave - West face of pulpitum
4		Nave - North wall and clearstorey
5		North Transept - West elevation
6		North Transept - North elevation
7		North Transept - East elevation
8		Presbytery - North elevation
9		Presbytery - East elevation
10		Presbytery - South and east elevations
11		South Choir Chapel - South elevation & South transept aisle - East elevation
12		South transept - South elevation
13		South transept - West elevation
14		Nave - South nave and clearstorey
15		Nave - South Aisle chapels 1-5
16		Nave - South aisle chapels 6-8
17		Nave - Monk's Choir. Pulpitum
18		Nave - Monk's Choir. Pulpitum North
19		Tower - West wall (East face)
20		North transept aisle - West, North and East walls
21		North transept - West, North and East walls
22		Presbytery - Presbytery and North choir aisle
23		South choir chapel - South and East walls
24		South transept - East aisle
25		South transept - West, South and East walls
26		Boundary walls - West, South and East walls - Both sides
27		Upper Bell Tower (Rope Access)



Click on link to open drawing in PDF viewer: [PIC157-HLZ-01B](#)

[PIC157-HLZ-02B](#)

[PIC157-HLZ-03B](#)

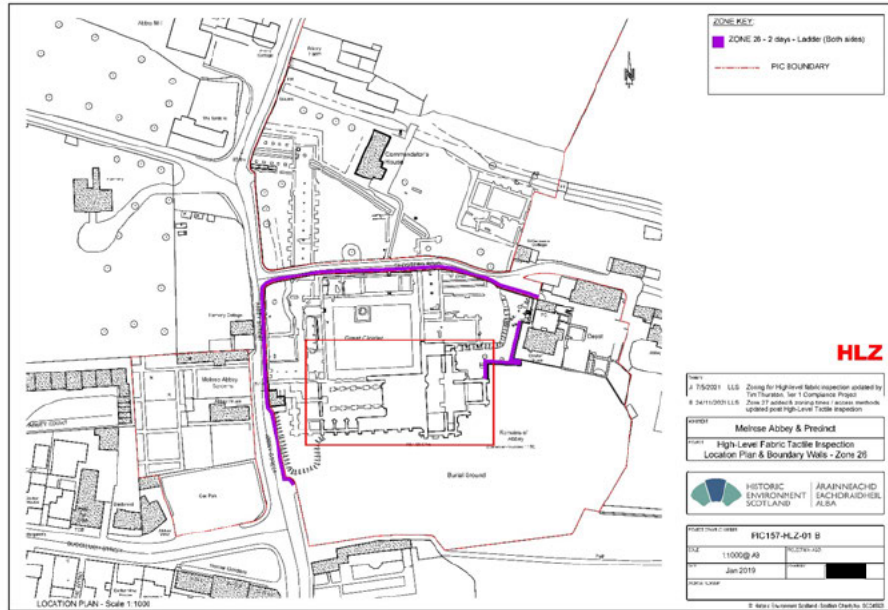

High-Level Tactile Inspection: Report - High-Level Zoning Drawings



ZONING 4.0 - 1.000 - 1.000	ZONING 4.0 - 1.000 - 1.000	ZONING 4.0 - 1.000 - 1.000
----------------------------	----------------------------	----------------------------

High-Level Tactile Inspection: Report - Summary dashboard



PIC ID# PIC157

Submission 10/02/2022

Number of zones 27

Select zone of which data should be displayed ↓ **All zones**

Number of observations 735

Identified Risk



Residual Risk

After Inspection Action



Residual Risk

Mitigated with applied Access Restriction in place



Inspection Action:

Class V Report = Fabric detached during tactile inspection	Access Restriction = Risk of fabric falling and causing harm			Monitor Observation / Plan Repairs = No immediate action
	Full site, notifiable	Partial site, notifiable	Partial site, not notifiable	
51	0	44	150	497

Inspection types:	Tactile	719	Visual	16

Key comments:



KEY FINDINGS

Melrose abbey features some of the most ornamental elements of medieval Scottish architecture. However, the ruined nature of the building exposes carved elements to the weather that were never designed to shed water. The abbey is predominantly built from sandstone while individual stones of the local breccia type building stone, 'Melrose Agglomerate', were found within the Abbey. This stone has very poor levels of cohesion and is vulnerable to fragmentation and crumbling, especially when exposed to high levels of moisture. The main sandstone is vulnerable to moisture driven decay resulting in large areas of surface scaling on ashlar masonry and delamination of projecting, edge- or face bedded elements e.g. gargoyles, mullions and tracery.

Melrose Abbey has had previous conservation work completed to secure and consolidate vulnerable stone. Although some of this work has lasted well and is still performing satisfactorily, some is now requiring further attention to ensure that it continues to keep the fabric in a stable and secure condition.

PREDOMINANT RISKS:

- Exposed window tracery is vulnerable to decay from erosion and structural stresses. The large presbytery windows are at particularly high risk of fabric fall due to split or misaligned stones as well as delaminating and scaling surfaces.
- The 17th century infill wall on the North side of the monk's nave is poorly consolidated with many stones and areas of mortar at the exposed East and West end at high risk of fall from substantial heights.
- Exposed ends of springing vault ribs inside the crossing were found to be delaminating with surfaces at risk of falling into the area below. Numerous vault ribs are delaminating, particularly where exposed.
- The West gable apex is one of the most exposed aspects of the abbey building and subsequently suffers advanced decay. The apex stone and ceiling arch hood moulding below are at high risk of fall from great height.
- Split and partially detached vault ribs were found in the South Aisles which, at present, are wedged in place but could fall if there was slight structural movement and these should be secured to prevent loss and remove risks to life.
- Partially detached sections of masonry were found in the remains of the springing arches in the North Transept as well as areas of fully detached masonry, all of which present risk of falls from height.
- Isolated stones of 'Melrose Agglomerate' were found on the wall head in the North Transept which were friable. These are likely to continue to deteriorate due to their exposed condition and the nature of the stone and lead to small to medium sized fragments falling from height.

High-Level Tactile Inspection: Report - Access Scope



PIC ID #	PIC157	Site name	Melrose Abbey & Precinct
-----------------	---------------	------------------	-------------------------------------

Access methods: Select all methods used to conduction inspection ↓

MEWP	Yes	Design Scaffold	No	Alloy Tower Scaffold	No
Rope Access	Yes	Steeplejack	No	Ladder	Yes
Ground	Yes	Binoculars / Photo	No	UAV	No

Other method	No	If yes, details:	
--------------	----	------------------	--

Ground protection / tracking required:	Yes
----------------------------------------	-----

External Contractor appointed for access requirments:	Yes
-------------------------------------------------------	-----

Inspection info:

Limitations of inspection:	<p>The high level tactile inspection of Melrose Abbey covered the all external elevations of the Abbey, internal (semi-enclosed) areas of the Abbey and both sides of the boundary wall surrounding the Abbey, where this was within HES ownership, subject to the limitations highlighted below.</p> <p>The South and North elevation clerestorey and upper buttress finials as well as the external West wall of the South transept, the monk's nave roof and the Presbytery roof could only be visually inspected from MEWPs. The North, South, East and West upper elevations (above the 22m reach of the MEWP) were inspected using rope access with live feedback via Go Pro cameras and radios. No inspections were completed to areas below 1500mm above ground or floor level. No inspection was completed of the walls of the Visitor Centre/Shop, which formed part of the boundary wall.</p> <p>While the tactile inspection was very detailed and carried out with great diligence, it is unlikely that 100% of risks will have been identified. As with every large scale survey, detail can be missed due to the angle of view, the size of the defect e.g. hairline cracks, and the quality of lighting. However, the inspection has identified the reasonably foreseeable risk of fabric fall at Melrose Abbey at the time of inspection.</p>
-----------------------------------	----------------------------------------------------------------------------------------------------------------------------------------------------------------------------------------------------------------------------------------------------------------------------------------------------------------------------------------------------------------------------------------------------------------------------------------------------------------------------------------------------------------------------------------------------------------------------------------------------------------------------------------------------------------------------------------------------------------------------------------------------------------------------------------------------------------------------------------------------------------------------------------------------------------------------------------------------------------------------------------------------------------------------------------------------------------------------------------------------------------------------------------------------------------------------------------------------------------------------------------------------------------------------------------------------------------------------------------------------------------

Areas not inspected:	<p>Enclosed internal spaces ie. the Sacristy, were not included in the inspection. Buildings and structures outwith the grounds of the abbey ie. the Visitor Centre, Brewery Yard, Priory Farm, Cloister House, Abbey House, the museum and surrounding grounds also did not form part of this inspection project.</p>
-----------------------------	------------------------------------------------------------------------------------------------------------------------------------------------------------------------------------------------------------------------------------------------------------------------------------------------------------------------

Click on link to open drawing in PDF viewer: [PIC157-HLZ-04B](#)

[PIC157-HLZ-05B](#)

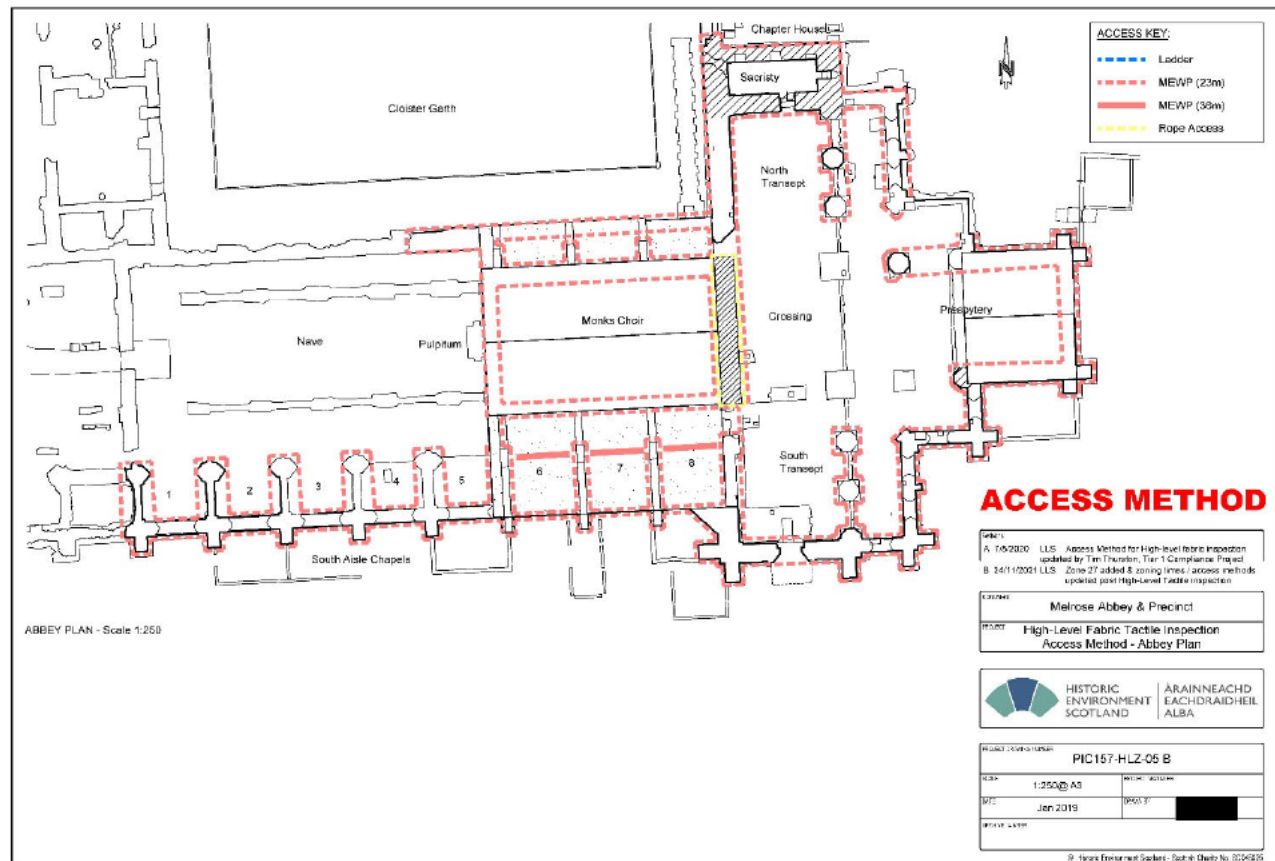
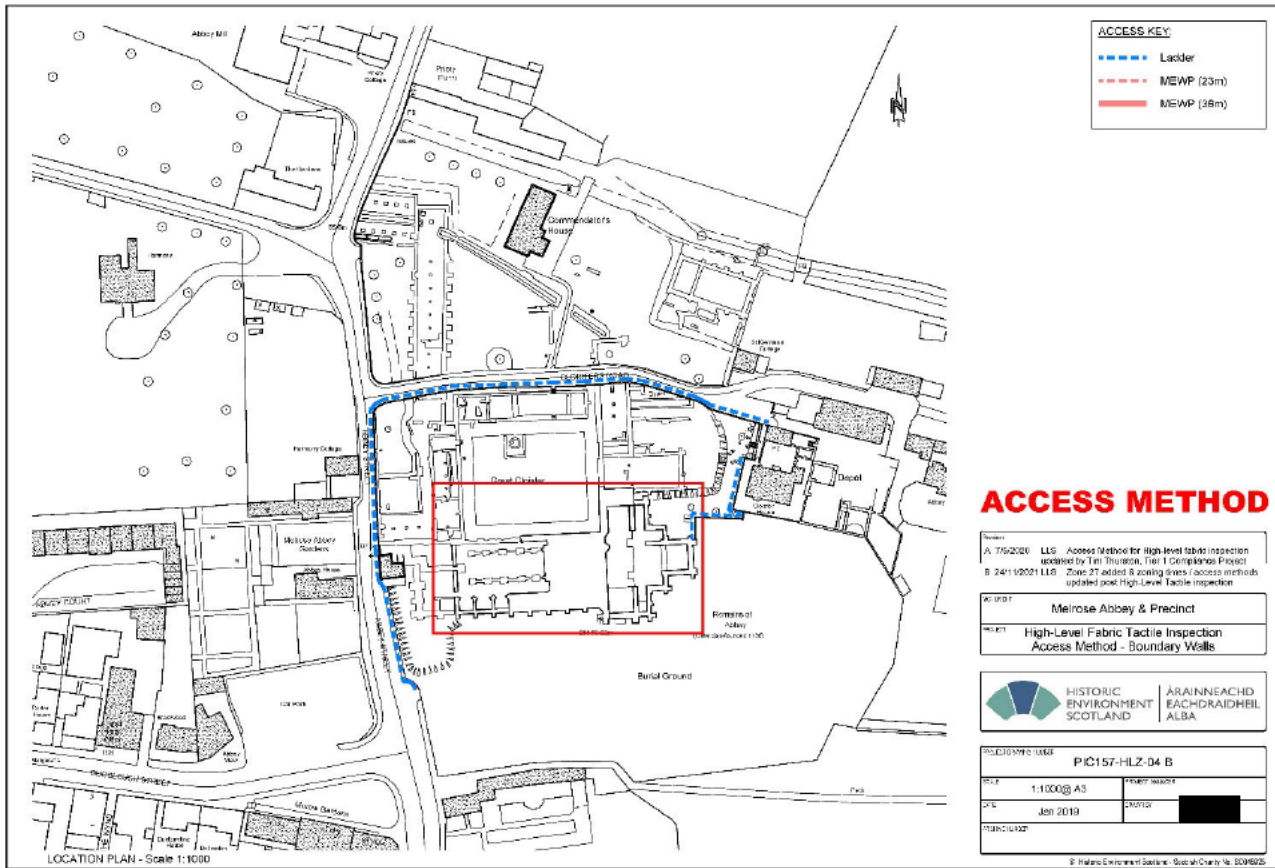



Click on link below image to open Interactive PDF in PDF viewer. In PDF viewer, the drawing is an interactive PDF, click on the labels to open the relevant OBS form for further information.

INTERACTIVE PDF
Click on labels to open relevant OBS form

LEGEND

- Green: Unrestored masonry
- Yellow: Unrestored masonry - to be restored
- Orange: Unrestored masonry - to be restored
- Red: Unrestored masonry - to be restored
- Dark Red: Unrestored masonry - to be restored
- Black: Unrestored masonry - to be restored

NOTE

- High Level Fairing: To provide protection & prevent water ingress
- Paintwork: To be replaced with a suitable paint

IDENTIFIED RISK

High Level Zone 01

PIC157-HLR-Z01

[PIC157-HLR-Z01](#)

INTERACTIVE PDF
Click on labels to open relevant OBS form

LEGEND

- Green: Unrestored masonry
- Yellow: Unrestored masonry - to be restored
- Orange: Unrestored masonry - to be restored
- Red: Unrestored masonry - to be restored
- Dark Red: Unrestored masonry - to be restored
- Black: Unrestored masonry - to be restored

NOTE

- High Level Fairing: To provide protection & prevent water ingress
- Paintwork: To be replaced with a suitable paint

IDENTIFIED RISK

High Level Zone 02

PIC157-HLR-Z02-B1

[PIC157-HLR-Z02-B1](#)

INTERACTIVE PDF
Click on labels to open relevant OBS form

LEGEND

- Green: Unrestored masonry
- Yellow: Unrestored masonry - to be restored
- Orange: Unrestored masonry - to be restored
- Red: Unrestored masonry - to be restored
- Dark Red: Unrestored masonry - to be restored
- Black: Unrestored masonry - to be restored

NOTE

- High Level Fairing: To provide protection & prevent water ingress
- Paintwork: To be replaced with a suitable paint

IDENTIFIED RISK

High Level Zone 03

PIC157-HLR-Z03

INTERACTIVE PDF
Click on labels to open relevant OBS form

LEGEND

- Green: Unrestored masonry
- Yellow: Unrestored masonry - to be restored
- Orange: Unrestored masonry - to be restored
- Red: Unrestored masonry - to be restored
- Dark Red: Unrestored masonry - to be restored
- Black: Unrestored masonry - to be restored

NOTE

- High Level Fairing: To provide protection & prevent water ingress
- Paintwork: To be replaced with a suitable paint

IDENTIFIED RISK

High Level Zone 04

PIC157-HLR-Z04



PIC157-HLR-Z02-B2

Click on link below image to open Interactive PDF in PDF viewer. In PDF viewer, the drawing is an interactive PDF, click on the labels to open the relevant OBS form for further information.

PIC157-HLR-Z02-B3

INTERACTIVE PDF
Click on label to open relevant OBS form.

Bay 4 - South elevation
Bay 4 - East elevation
Bay 4 - South inner elevation
Bay 4 - West elevation
Bay 4 - Roof

IDENTIFIED RISK

PIC157 HLR Z02 B2

INTERACTIVE PDF
Click on label to open relevant OBS form.

Bay 5 - South elevation
Bay 5 - East elevation
Bay 5 - West elevation
Bay 5 - Roof

IDENTIFIED RISK

PIC157 HLR Z02 B3

INTERACTIVE PDF
Click on label to open relevant OBS form.

South Elevation
West Elevation

IDENTIFIED RISK

PIC157 HLR Z02 B4

INTERACTIVE PDF
Click on label to open relevant OBS form.

IDENTIFIED RISK

PIC157 HLR Z02 B5

High-Level Tactile Inspection: Report - Risk Drawings



Click on link below image to open Interactive PDF in PDF viewer. In PDF viewer, the drawing is an interactive PDF, click on the labels to open the relevant OBS form for further information.

INTERACTIVE PDF
Click on label to open
Relevant OBS form

IDENTIFIED RISK

High-Level Zone 03
Melrose Abbey - East Elevation

INTERACTIVE PDF
Click on label to open
Relevant OBS form

IDENTIFIED RISK

High-Level Zone 04
Melrose Abbey - East Elevation

INTERACTIVE PDF
Click on label to open
Relevant OBS form

IDENTIFIED RISK

High-Level Zone 03
Melrose Abbey - West Elevation

INTERACTIVE PDF
Click on label to open
Relevant OBS form

IDENTIFIED RISK

High-Level Zone 04
Melrose Abbey - South Elevation

High-Level Tactile Inspection: Report - Risk Drawings



Click on link below image to open Interactive PDF in PDF viewer. In PDF viewer, the drawing is an interactive PDF, click on the labels to open the relevant OBS form for further information.

INTERACTIVE PDF
Click on labels to open relevant OBS form.

KEY

- Low identified risk
- Medium identified risk
- High identified risk
- Low identified risk
- Medium identified risk
- High identified risk
- Low identified risk
- Medium identified risk
- High identified risk
- Low identified risk
- Medium identified risk
- High identified risk
- Low identified risk
- Medium identified risk
- High identified risk

NOTE

- 1. All work should be done in accordance with the relevant standards and specifications.
- 2. All work should be done in accordance with the relevant standards and specifications.
- 3. All work should be done in accordance with the relevant standards and specifications.

HIGH-LEVEL FABRIC TACTILE INSPECTION 15/03/2021 to 15/03/2021

SITE PLAN 1:200

PROJECT	PC157 Melrose Abbey
DRAWING TITLE	High-Level Tactile Inspection
DATE	15/03/2021
AUTHOR	AMARACHATI
DATE	15/03/2021
PROJECT NO.	PC157-2101
DRAWING NO.	HTI-09
DATE	15/03/2021
AUTHOR	AMARACHATI

High-Level Zone 09
Melrose Abbey - High-Level Tactile Inspection

INTERACTIVE PDF
Click on labels to open relevant OBS form.

KEY

- Low identified risk
- Medium identified risk
- High identified risk
- Low identified risk
- Medium identified risk
- High identified risk
- Low identified risk
- Medium identified risk
- High identified risk
- Low identified risk
- Medium identified risk
- High identified risk
- Low identified risk
- Medium identified risk
- High identified risk

NOTE

- 1. All work should be done in accordance with the relevant standards and specifications.
- 2. All work should be done in accordance with the relevant standards and specifications.
- 3. All work should be done in accordance with the relevant standards and specifications.

HIGH-LEVEL FABRIC TACTILE INSPECTION 15/03/2021 to 15/03/2021

SITE PLAN 1:200

PROJECT	PC157 Melrose Abbey
DRAWING TITLE	High-Level Tactile Inspection
DATE	15/03/2021
AUTHOR	AMARACHATI
DATE	15/03/2021
PROJECT NO.	PC157-2101
DRAWING NO.	HTI-10
DATE	15/03/2021
AUTHOR	AMARACHATI

High-Level Zone 10
Melrose Abbey - High-Level Tactile Inspection

INTERACTIVE PDF
Click on labels to open relevant OBS form.

KEY

- Low identified risk
- Medium identified risk
- High identified risk
- Low identified risk
- Medium identified risk
- High identified risk
- Low identified risk
- Medium identified risk
- High identified risk
- Low identified risk
- Medium identified risk
- High identified risk
- Low identified risk
- Medium identified risk
- High identified risk

NOTE

- 1. All work should be done in accordance with the relevant standards and specifications.
- 2. All work should be done in accordance with the relevant standards and specifications.
- 3. All work should be done in accordance with the relevant standards and specifications.

HIGH-LEVEL FABRIC TACTILE INSPECTION 15/03/2021 to 15/03/2021

SITE PLAN 1:200

PROJECT	PC157 Melrose Abbey
DRAWING TITLE	High-Level Tactile Inspection
DATE	15/03/2021
AUTHOR	AMARACHATI
DATE	15/03/2021
PROJECT NO.	PC157-2101
DRAWING NO.	HTI-11
DATE	15/03/2021
AUTHOR	AMARACHATI

INTERACTIVE PDF
Click on labels to open relevant OBS form.

KEY

- Low identified risk
- Medium identified risk
- High identified risk
- Low identified risk
- Medium identified risk
- High identified risk
- Low identified risk
- Medium identified risk
- High identified risk
- Low identified risk
- Medium identified risk
- High identified risk
- Low identified risk
- Medium identified risk
- High identified risk

NOTE

- 1. All work should be done in accordance with the relevant standards and specifications.
- 2. All work should be done in accordance with the relevant standards and specifications.
- 3. All work should be done in accordance with the relevant standards and specifications.

HIGH-LEVEL FABRIC TACTILE INSPECTION 15/03/2021 to 15/03/2021

SITE PLAN 1:200

PROJECT	PC157 Melrose Abbey
DRAWING TITLE	High-Level Tactile Inspection
DATE	15/03/2021
AUTHOR	AMARACHATI
DATE	15/03/2021
PROJECT NO.	PC157-2101
DRAWING NO.	HTI-12
DATE	15/03/2021
AUTHOR	AMARACHATI



High-Level Zone 11
Melrose Abbey - Bay 7 - Choir Chancel - South elevation & Bay 7 transept & East elevation

IDENTIFIED RISK

PROJECT: Melrose Abbey
High-Level Tactile Survey Inspection
16/05/2022 to 16/05/2022

PROJECT MANAGER: [Redacted]
DATE: 16/05/2022

High-Level Zone 12
Melrose Abbey - Bay 7 Transept South Elevation

IDENTIFIED RISK

PROJECT: Melrose Abbey
High-Level Tactile Survey Inspection
16/05/2022 to 16/05/2022

PROJECT MANAGER: [Redacted]
DATE: 16/05/2022

Click on link below image to open Interactive PDF in PDF viewer. In PDF viewer, the drawing is an interactive PDF, click on the labels to open the relevant OBS form for further information.

High-Level Zone 13
Melrose Abbey - Bay 7 Transept - West Elevation

IDENTIFIED RISK

PROJECT: Melrose Abbey
High-Level Tactile Survey Inspection
16/05/2022 to 16/05/2022

PROJECT MANAGER: [Redacted]
DATE: 16/05/2022

High-Level Fabric Tactile Inspection 16/05/2022 to 16/05/2022

SITE PLAN 1303

High-Level Zone 14
Melrose Abbey - Bay 7 Transept & East Elevation

IDENTIFIED RISK

PROJECT: Melrose Abbey
High-Level Tactile Survey Inspection
16/05/2022 to 16/05/2022

PROJECT MANAGER: [Redacted]
DATE: 16/05/2022

High-Level Fabric Tactile Inspection 16/05/2022 to 16/05/2022

SITE PLAN 1304

High-Level Zone 15
Melrose Abbey - Bay 8 - West Elevation

IDENTIFIED RISK

PROJECT: Melrose Abbey
High-Level Tactile Survey Inspection
16/05/2022 to 16/05/2022

PROJECT MANAGER: [Redacted]
DATE: 16/05/2022

High-Level Fabric Tactile Inspection 16/05/2022 to 16/05/2022

SITE PLAN 1305

High-Level Zone 16
Melrose Abbey - Bay 8 - South Roof, Bay 8 - North Roof, Bay 8 - West Elevations

IDENTIFIED RISK

PROJECT: Melrose Abbey
High-Level Tactile Survey Inspection
16/05/2022 to 16/05/2022

PROJECT MANAGER: [Redacted]
DATE: 16/05/2022

High-Level Fabric Tactile Inspection 16/05/2022 to 16/05/2022

SITE PLAN 1306



High-Level Zone 15
Melrose Abbey - South - South West and elevations

IDENTIFIED RISK

PROJECT Melrose Abbey
High Level Tactile Inspection
Identified Risk - High Level Zone 15

NO. 1000
ARCHITECTURAL
DRAWINGS
SCOTLAND
ACT 1995

PROJECT/CLIENT
NO. 1000
DATE 2021

202106-15

High-Level Zone 16
Melrose Abbey - Bay 6 - South - North - East

IDENTIFIED RISK

PROJECT Melrose Abbey
High Level Tactile Inspection
Identified Risk - High Level Zone 16

NO. 1000
ARCHITECTURAL
DRAWINGS
SCOTLAND
ACT 1995

PROJECT/CLIENT
NO. 1000
DATE 2021

202106-16

Click on link below image to open Interactive PDF in PDF viewer. In PDF viewer, the drawing is an interactive PDF, click on the labels to open the relevant OBS form for further information.

INTERACTIVE PDF
Click on label to open relevant OBS form.

High-Level Zone 16
Melrose Abbey - Bay 7 - South - North - West

IDENTIFIED RISK

PROJECT Melrose Abbey
High Level Tactile Inspection
Identified Risk - High Level Zone 16

NO. 1000
ARCHITECTURAL
DRAWINGS
SCOTLAND
ACT 1995

PROJECT/CLIENT
NO. 1000
DATE 2021

202106-16

INTERACTIVE PDF
Click on label to open relevant OBS form.

High-Level Zone 16
Melrose Abbey - Bay 8 - South - North - West

IDENTIFIED RISK

PROJECT Melrose Abbey
High Level Tactile Inspection
Identified Risk - High Level Zone 16

NO. 1000
ARCHITECTURAL
DRAWINGS
SCOTLAND
ACT 1995

PROJECT/CLIENT
NO. 1000
DATE 2021

202106-16

INTERACTIVE PDF
Click on label to open relevant OBS form.

High-Level Zone 16
Melrose Abbey - South Roof

IDENTIFIED RISK

PROJECT Melrose Abbey
High Level Tactile Inspection
Identified Risk - High Level Zone 16

NO. 1000
ARCHITECTURAL
DRAWINGS
SCOTLAND
ACT 1995

PROJECT/CLIENT
NO. 1000
DATE 2021

202106-16

INTERACTIVE PDF
Click on label to open relevant OBS form.

High-Level Zone 16
Melrose Abbey - West Elevation

IDENTIFIED RISK

PROJECT Melrose Abbey
High Level Tactile Inspection
Identified Risk - High Level Zone 16

NO. 1000
ARCHITECTURAL
DRAWINGS
SCOTLAND
ACT 1995

PROJECT/CLIENT
NO. 1000
DATE 2021

202106-16

High-Level Tactile Inspection: Report - Risk Drawings



IDENTIFIED RISK

High-Level Zone 17
Melrose Abbey - East - North's East Pavilion

IDENTIFIED RISK

High-Level Zone 18
Melrose Abbey - West - West's East Pavilion - Bay 6

Click on link below image to open Interactive PDF in PDF viewer. In PDF viewer, the drawing is an interactive PDF, click on the labels to open the relevant OBS form for further information.

INTERACTIVE PDF
Click on label to open relevant OBS form

IDENTIFIED RISK

High-Level Zone 19
Melrose Abbey - West - West's East Pavilion - Bay 7

INTERACTIVE PDF
Click on label to open relevant OBS form

IDENTIFIED RISK

High-Level Zone 18
Melrose Abbey - West - West's East Pavilion - Bay 8

INTERACTIVE PDF
Click on label to open relevant OBS form

IDENTIFIED RISK

High-Level Zone 19
Melrose Abbey - West - West's East Pavilion - Bay 7

INTERACTIVE PDF
Click on label to open relevant OBS form

IDENTIFIED RISK

High-Level Zone 18
Melrose Abbey - West - West's East Pavilion - Bay 8

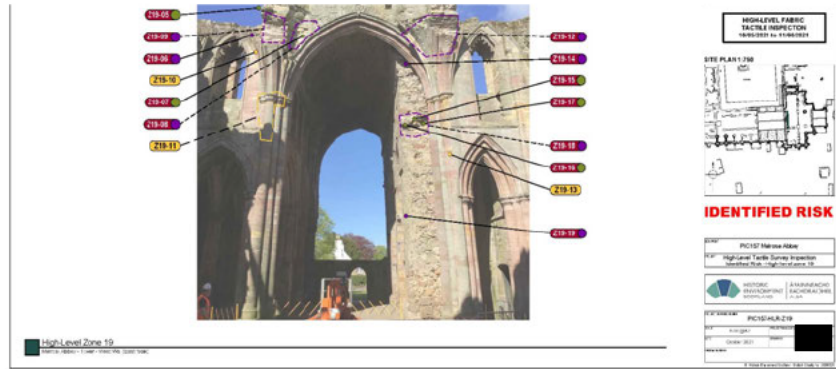

Click on link below image to open Interactive PDF in PDF viewer. In PDF viewer, the drawing is an interactive PDF, click on the labels to open the relevant OBS form for further information.

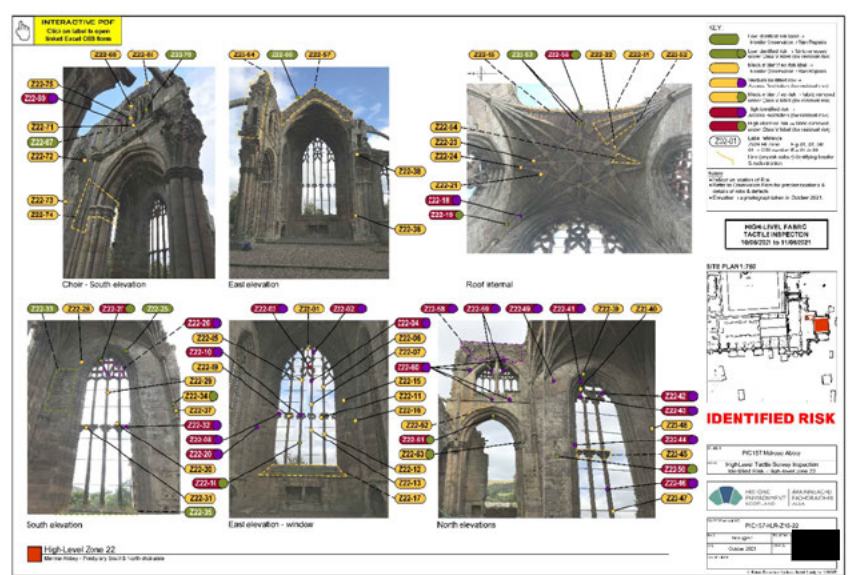
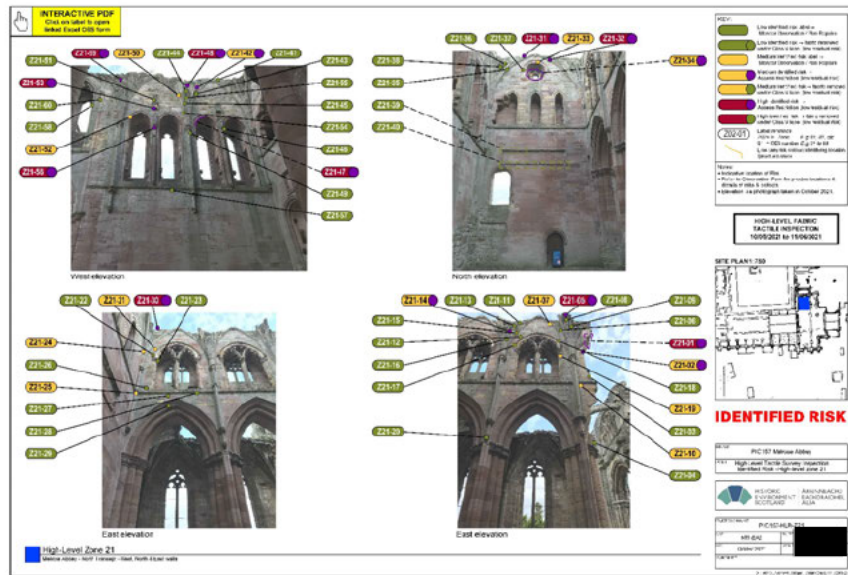

High-Level Tactile Inspection: Report - Risk Drawings

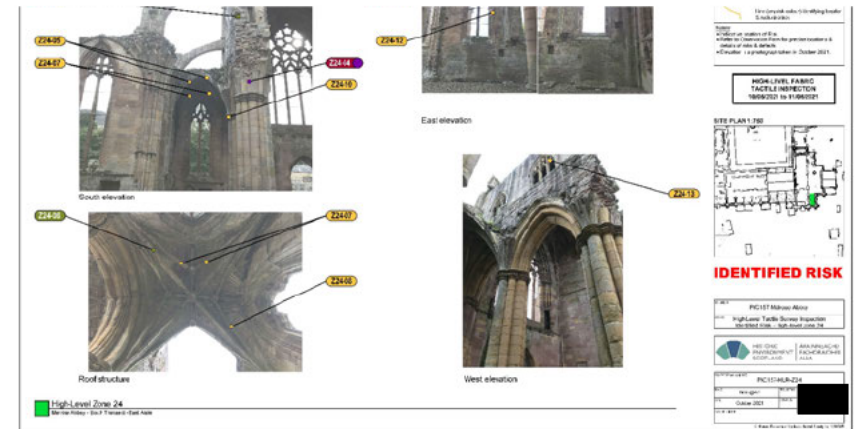

Click on link below image to open Interactive PDF in PDF viewer. In PDF viewer, the drawing is an interactive PDF, click on the labels to open the relevant OBS form for further information.

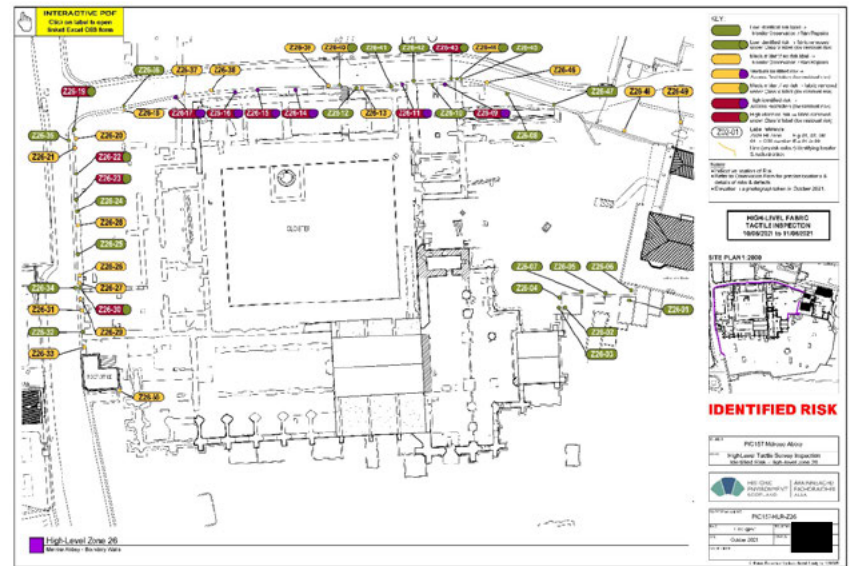
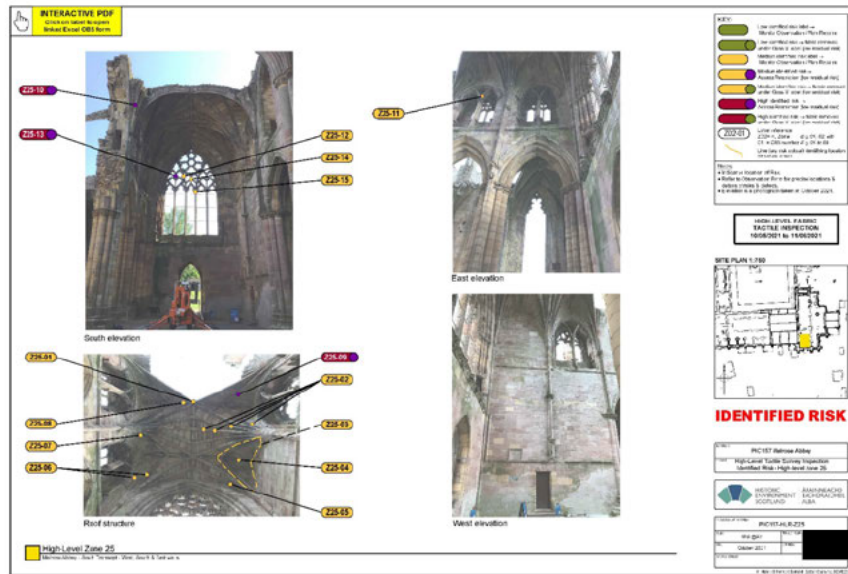

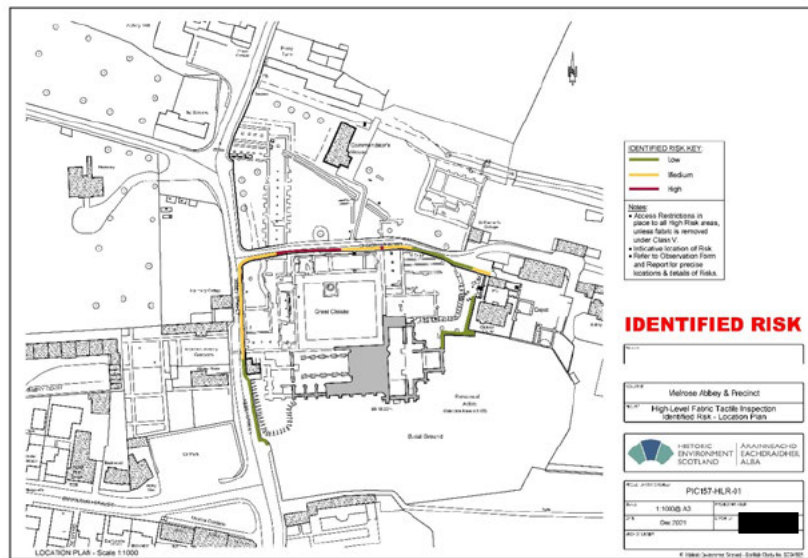
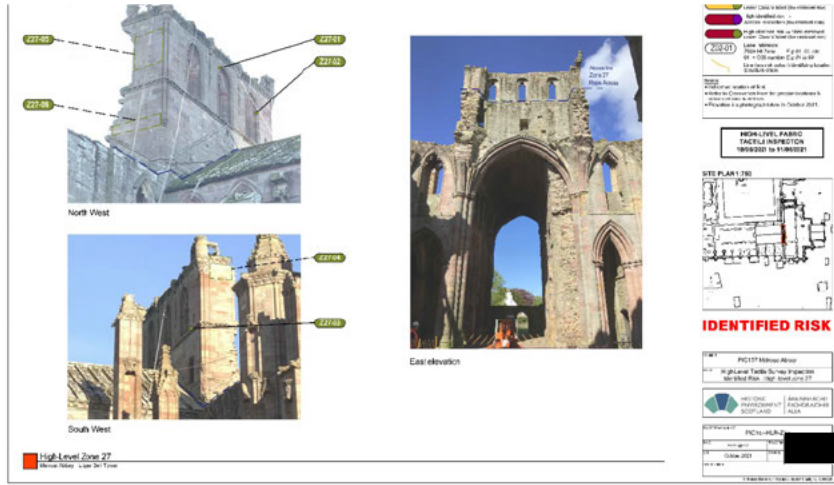

PIC157-HLR-01

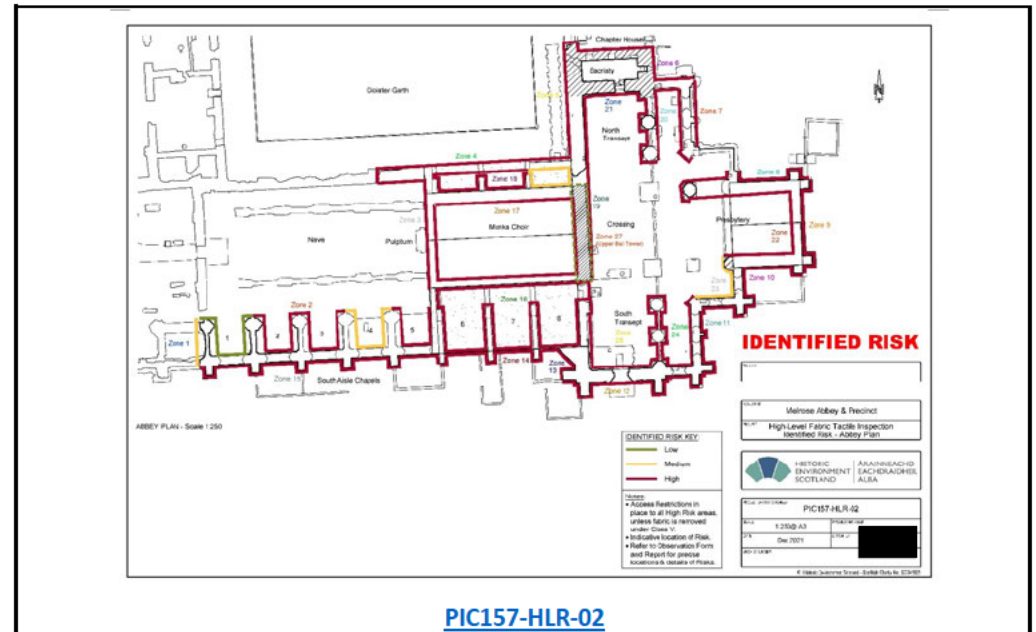

PIC157-HLR-02



Click on link below image to open PDF in PDF viewer.

